

TERMOMIX MIXING VALVES D AND C

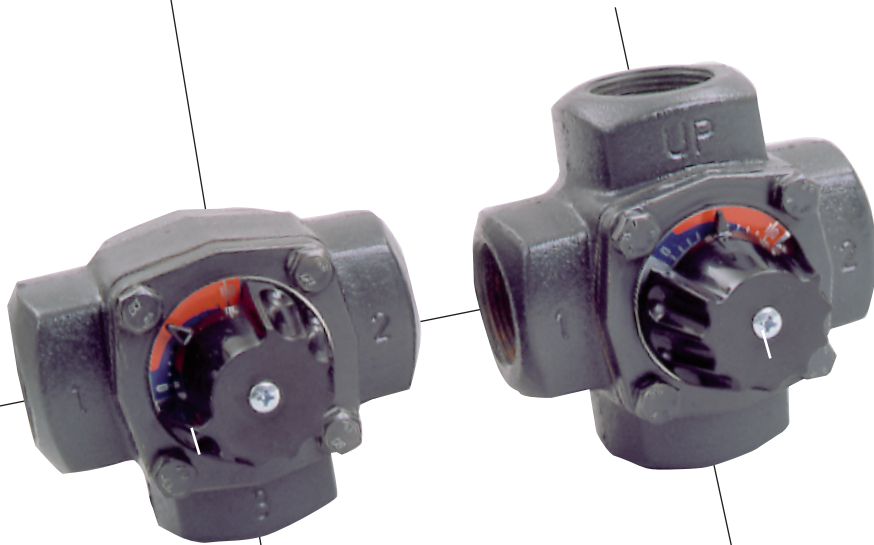

TECHNICAL DATA

Max. operating temperature	110°C
Max. operating pressure	1,0 MPa (10 bar)
Angle of rotation	90°
Torque	0,2 Nm for 3-way valves 0,1 Nm för 4-way valves
Valve body	Cast iron
Slide	Brass
Cover	Aluminium
Spindle	Brass
Spindle sealing	Two O-rings, EPDM
Motorizing	Suitable for all valve motors

TERMOMIX 3-way and 4-way mixing valves of cast iron have been developed especially for hydronic heating systems, boilers, heat exchangers and air heating/cooling applications. TERMOMIX valves can be used as mixing valves or as diverting valves. There are several ways of installing. TERMOMIX valves have excellent control characteristics. They control both supply and return lines. The valves can be mounted in any position. TERMOMIX valves are very suitable for motorizing because of their low torque. The valves are available for right-hand and left-hand mounting.

ORDERING DATA

Order No:	Type:		
2320	TERMOMIX D 20	Rp 3/4"	3-way mixing valve
2325	TERMOMIX D 25	Rp 1"	3-way mixing valve
2332	TERMOMIX D 32	Rp 1 1/4"	3-way mixing valve
2340	TERMOMIX D 40	Rp 1 1/2"	3-way mixing valve
2350	TERMOMIX D 50	Rp 2"	3-way mixing valve
2420	TERMOMIX C 20	Rp 3/4"	4-way mixing valve
2425	TERMOMIX C 25	Rp 1"	4-way mixing valve
2432	TERMOMIX C 32	Rp 1 1/4"	4-way mixing valve
2440	TERMOMIX C 40	Rp 1 1/2"	4-way mixing valve
2450	TERMOMIX C 50	Rp 2"	4-way mixing valve

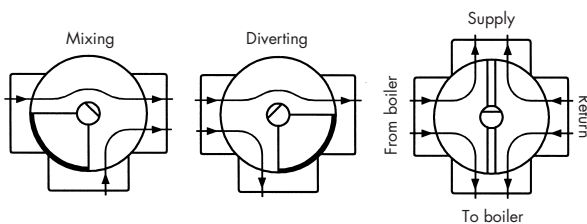

LK ACASO AB
Box 634
SE-521 21 Falköping
Tel: +46 515 107 50
Fax: +46 515 590 30

E-mail: info@lkacaso.se
Internet: www.lkacaso.se



LK Acaso

TERMOMIX MIXING VALVES D AND C

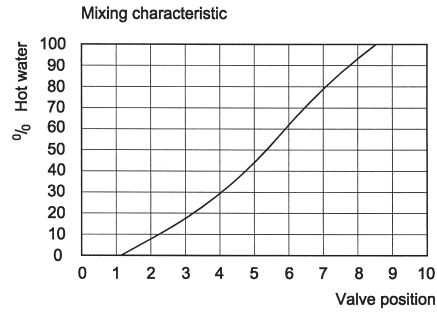
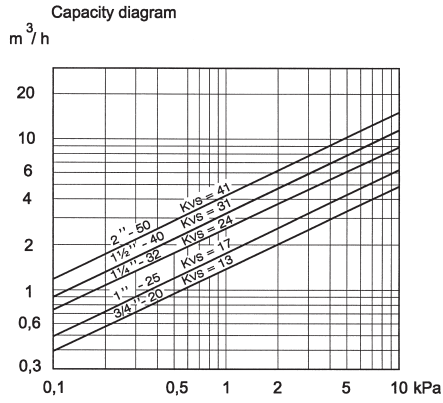

TERMOMIX D 3-WAY MIXING VALVES

Order No	Type	Kvs	A mm	B mm	C mm	D mm	E mm	Weight kg
2320	D 20	13	20 - Rp 3/4"	110	32	67	92	1,7
2325	D 25	17	25 - Rp 1"	112	32	67	94	1,8
2332	D 32	24	32 - Rp 1 1/4"	127	36	70	100	2,4
2340	D 40	31	40 - Rp 1 1/2"	127	40	73	101	2,7
2350	D 50	41	50 - Rp 2"	135	48	80	105	4,1

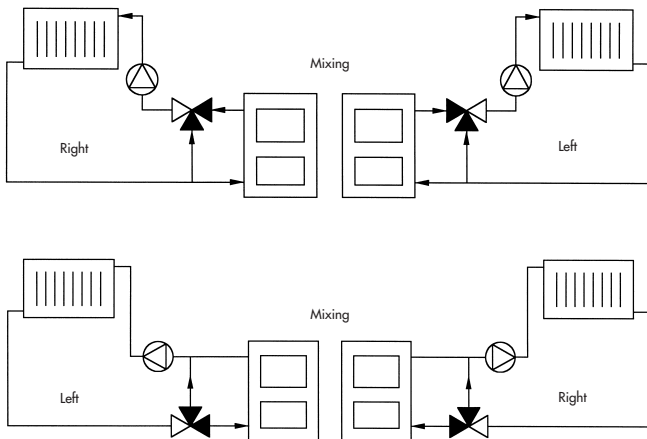
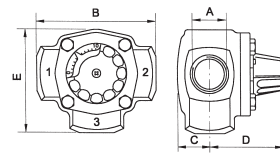

TERMOMIX C 4-WAY MIXING VALVES

Order No	Type	Kvs	A mm	B mm	C mm	D mm	E mm	Weight kg
2420	C 20	13	20 - Rp 3/4"	110	32	67	110	1,8
2425	C 25	17	25 - Rp 1"	112	32	67	112	1,9
2432	C 32	24	32 - Rp 1 1/4"	127	36	70	127	2,6
2440	C 40	31	40 - Rp 1 1/2"	127	40	73	127	3,1
2450	C 50	41	50 - Rp 2"	135	48	80	135	4,6

